

1941-50

# REPAIR PARTS CATALOG

FOR

For Model PO-15

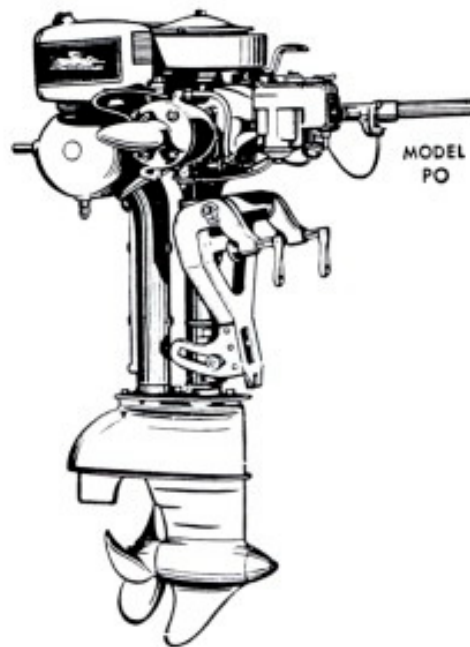

## JOHNSON MOTORS

Waukegan, Illinois, U. S. A.

## Contact Your Johnson Sea Horse Dealer for Replacement Parts, Information On Part Prices and Johnson Service.

### Care of Motors When Used in Salt Water

Regardless of the material used in the construction of an outboard motor, it will corrode and tarnish to a certain extent when used in salt water. It is of importance, therefore, to adhere closely to the following instructions if you want to receive the most from your motor.

1. Remove the motor from the boat when it is not in service.
2. Flush out the cooling system as soon as possible.
3. Rinse off thoroughly with fresh water.
4. Wipe dry with a cloth.
5. Go over all the bright parts with an oily cloth, especially if the motor is to be stored for any length of time.

### Warranty

All Johnson Motors (racing models excepted) are warranted to be free from defects in material and workmanship under normal use and service, our obligation under this Warranty being limited to making good at our factory in Waukegan, Illinois, any part or parts thereof which shall, within three months after date of delivery to owner, be returned to us with transportation charges prepaid, and which our examination shall disclose to our satisfaction to have been thus defective, this Warranty being expressly in lieu of all other warranties and representations, express or implied, and of all other liabilities in connection with the sale or use of our outboard motors.

This Warranty shall not apply to any outboard motor which shall have been repaired or altered outside of the factory in any way so as in our judgment, to affect its stability or reliability, nor which has been subject to misuse, negligence or accident.

#### CLAIMS MUST BE ENTERED ON ALL RETURNED GOODS

Regular claim forms are provided all our dealers, service stations and distributors. All claims must be entered on this form, No. SE-16, before parts are returned to factory. No part will be replaced unless this form is used. See your dealers for claim form.

All material—motors or parts—be returned to your nearest service station or dealer—TRANSPORTATION CHARGES PREPAID.

REMEMBER—ALWAYS request a claim form and properly fill it in before returning any material to our service station or distributor.

#### WARRANTY DOES NOT APPLY TO RACING MOTORS

Due to the excessive strains and stresses placed upon motors when used for racing, all Johnson motors of racing model or all other models when used for racing are sold with the distinct understanding that they are not guaranteed in any manner, and Johnson Motors does not assume any responsibility for injury or damage sustained from their use thereof.

Always Give Part Number and Motor Number

**POWER HEAD PARTS**

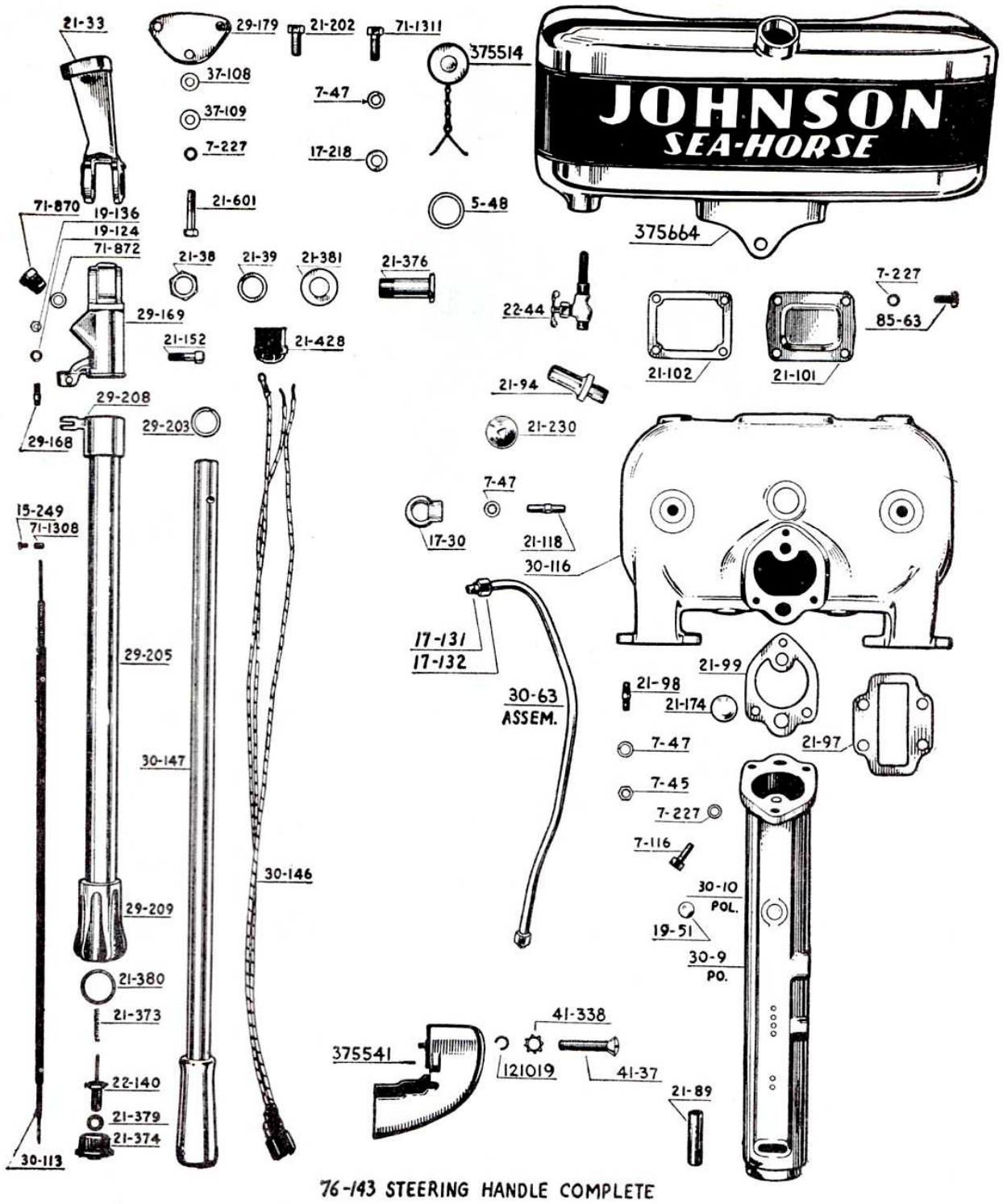

76-143 STEERING HANDLE COMPLETE

Order All Parts from Nearest Dealer or Service Station



Always Give Part Number and Motor Number

**POWER HEAD PARTS**

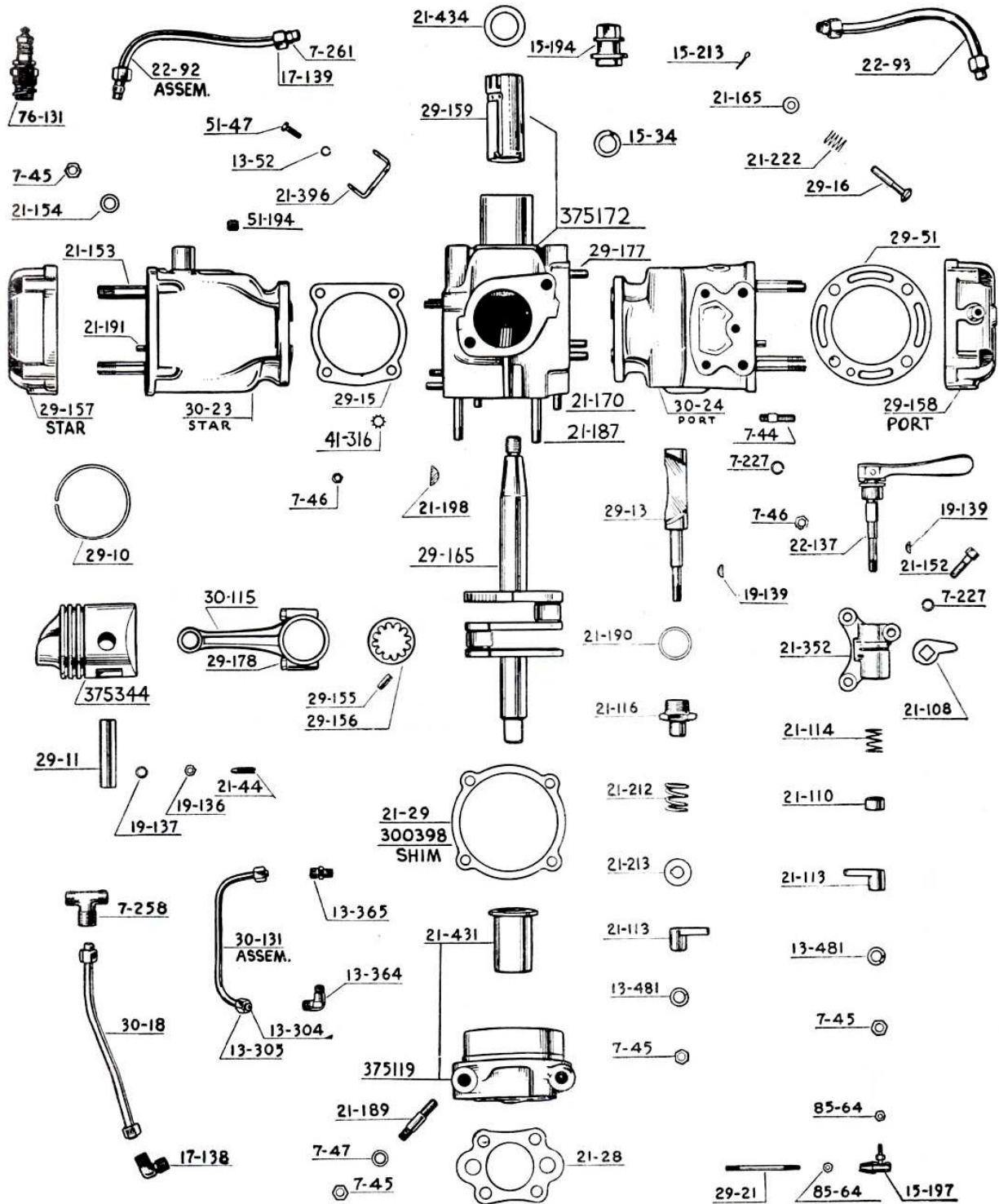

30-119 PISTON AND CONNECTING ROD ASSEMBLY, LESS BEARING  
 30-122 CRANKCASE AND CRANKCASE HEAD WITH BEARINGS

Order All Parts from Nearest Dealer or Service Station

Always Give Part Number and Motor Number

**LOWER UNIT PARTS**

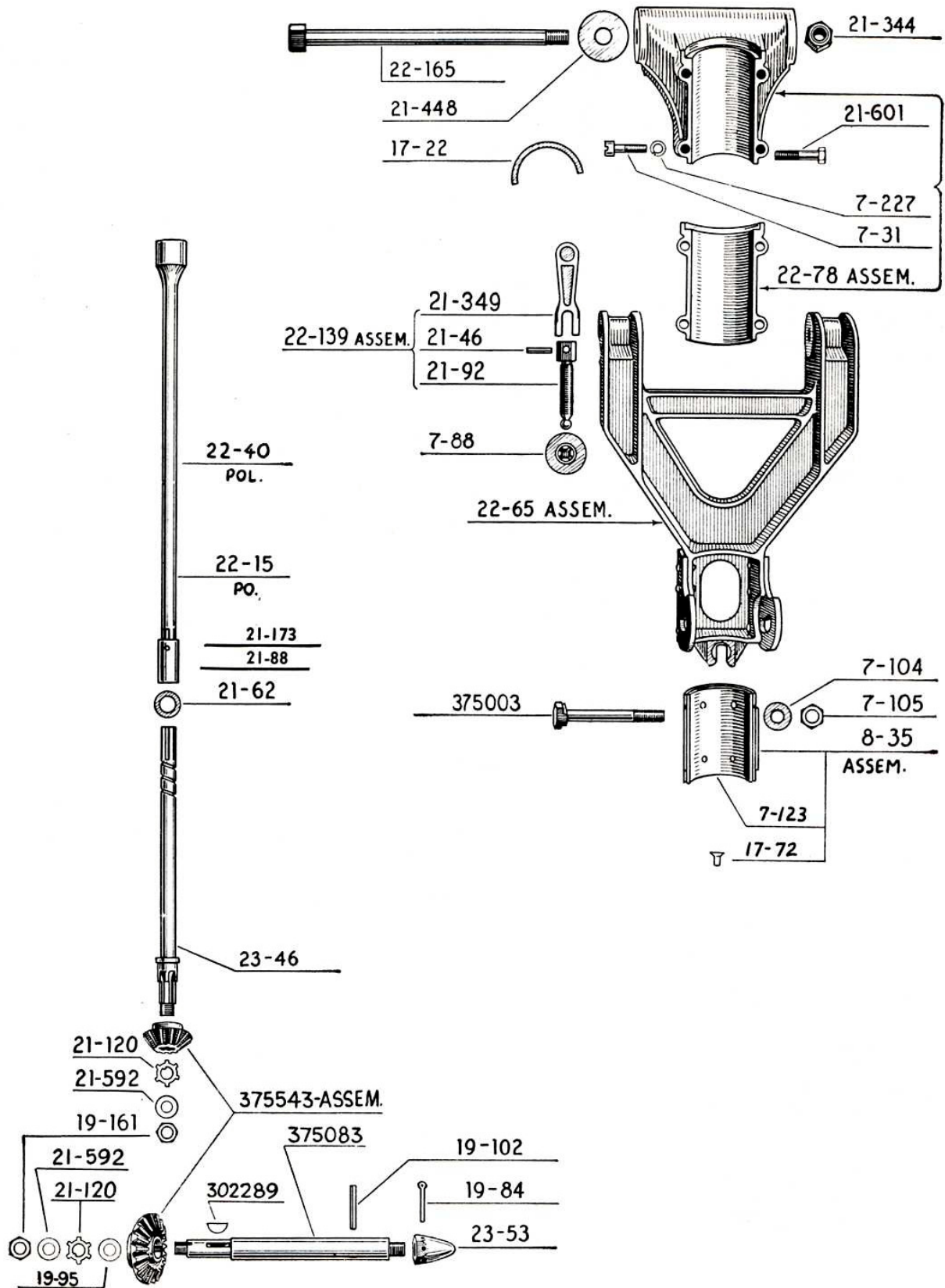

Order All Parts from Nearest Dealer or Service Station

Always Give Part Number and Motor Number

**LOWER UNIT PARTS**

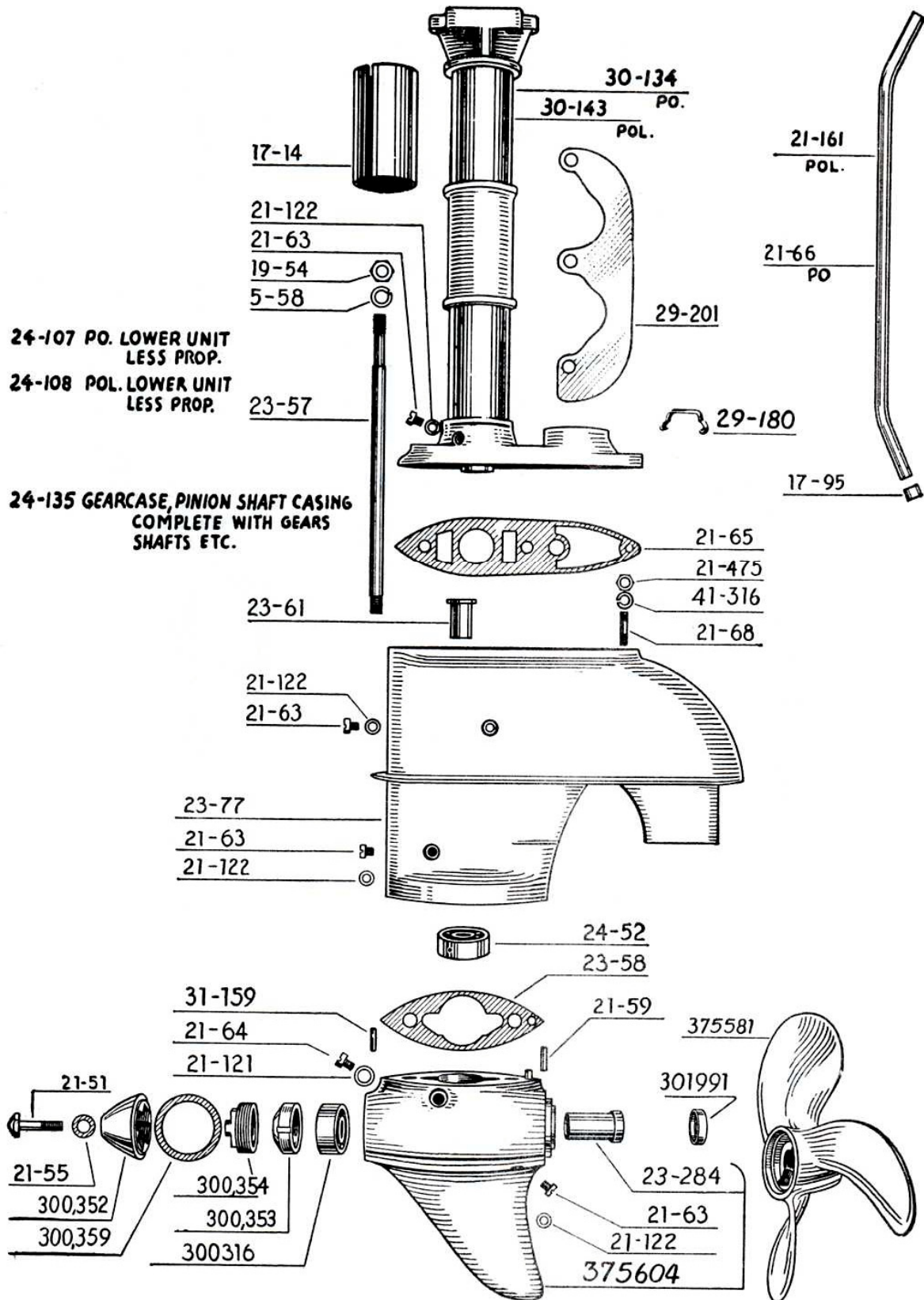

Order All Parts from Nearest Dealer or Service Station



Always Give Part Number and Motor Number

**MAGNETO PARTS**

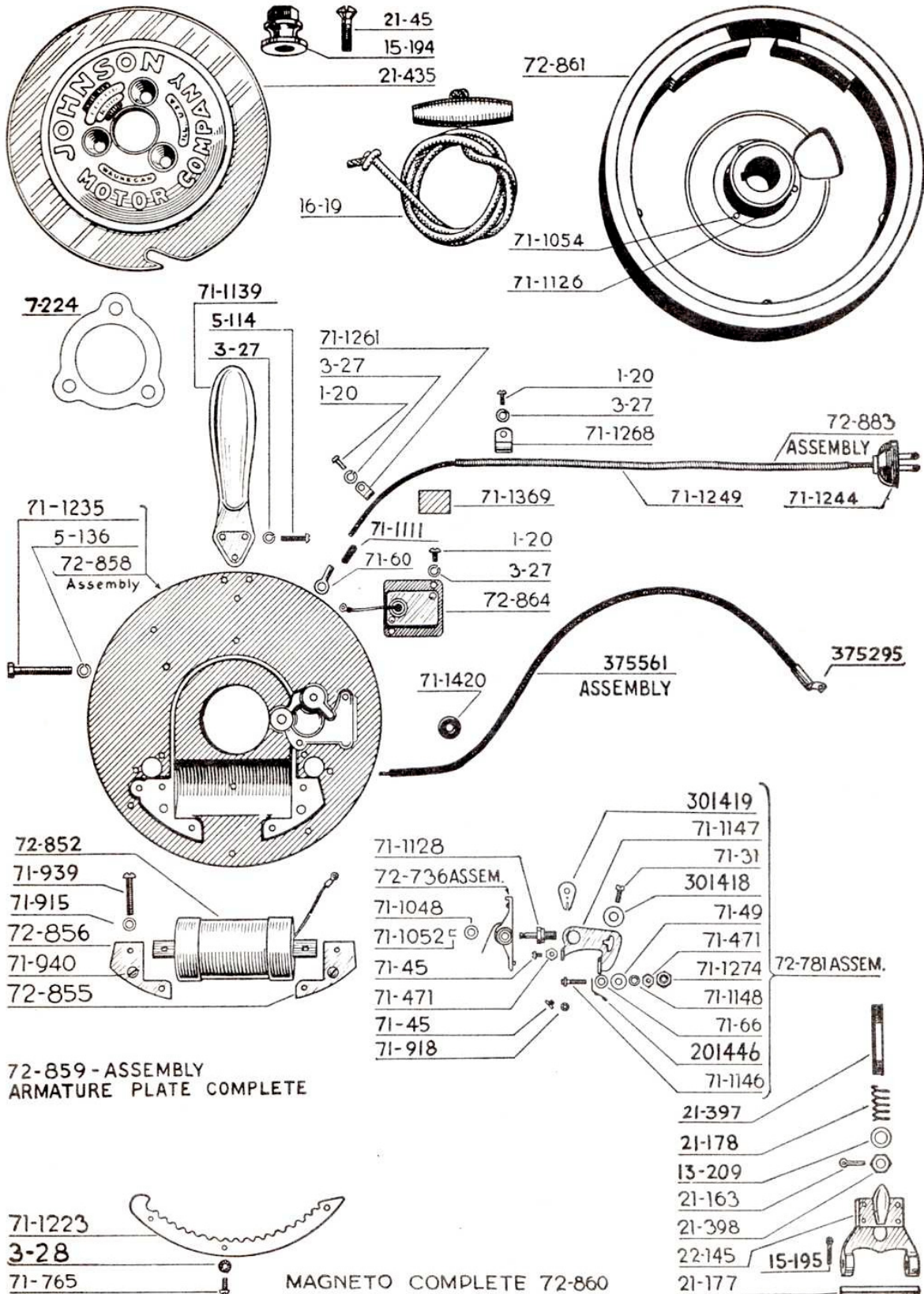

Order All Parts from Nearest Dealer or Service Station

Always Give Part Number and Motor Number

### CARBURETOR PARTS

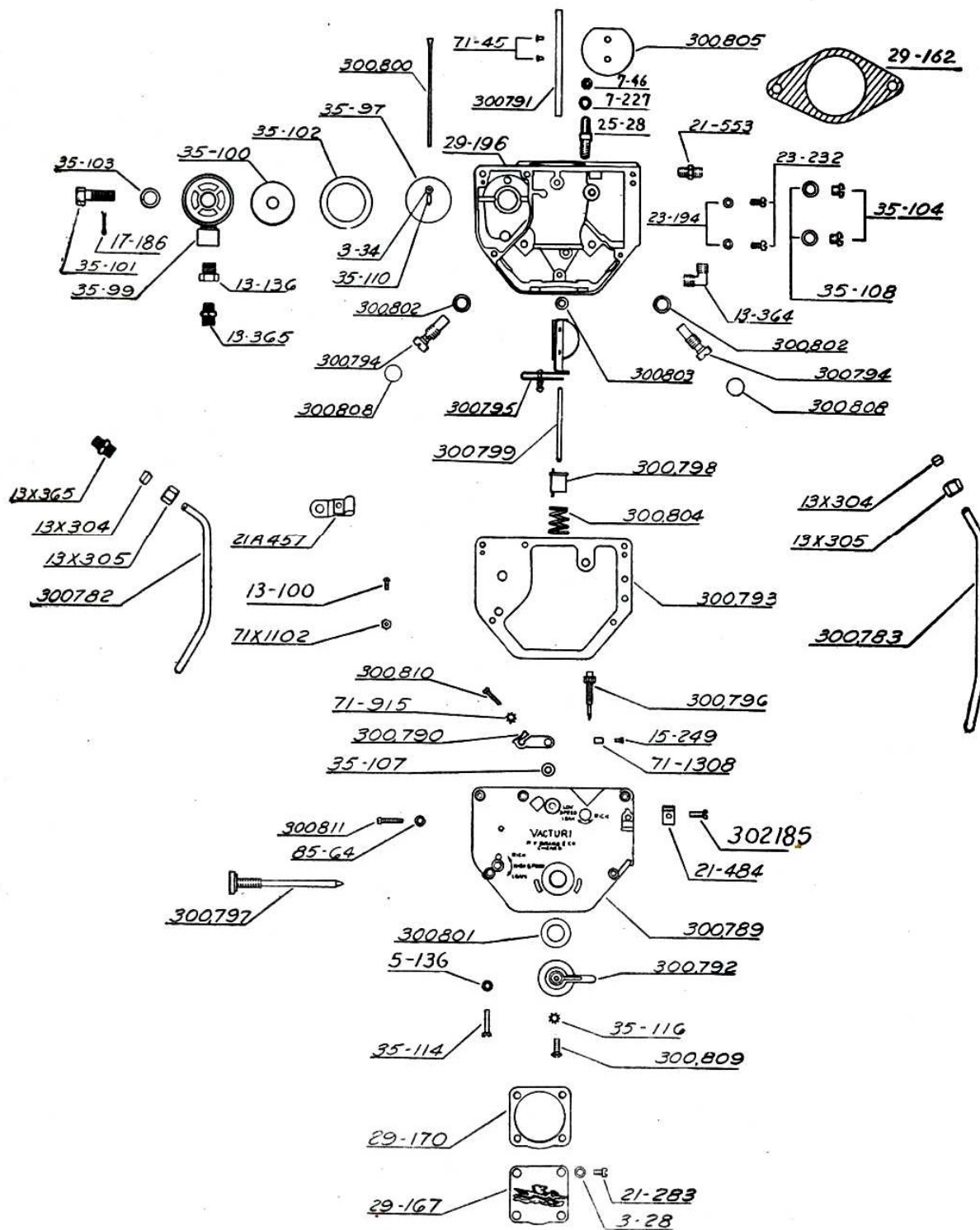

Order All Parts from Nearest Dealer or Service Station



**Always Give Part Number and Motor Number**

**PARTS FOR PO-15—Cont.**

Part No.	No. Required per Motor	NAME OF PART
19-95	1	Washer - Propeller Nut.....
19-102	1	Drive Pin - Propeller.....
19-124	1	Lockwasher - Clamp Screw Nut.....
*19-124	6	Lockwasher - Exhaust Cutout Assembly.....
19-136	3	Nut - Wrist Pin Lock Screw - Clamp Screw Control Cable.....
19-137	2	Lockwasher - Wrist Pin Lock Screw.....
19-139	2	Key - Bypass Valve Lever - Relief Valve Shaft.....
19-161	2	Nut - Pinion and Propeller Shaft.....
21-28	1	Gasket - Crankcase Head to Lower Unit.....
21-29	1	Gasket - Crankcase Head to Crankcase.....
21-33	1	Bracket - Steering Handle.....
21-38	2	Nut - Hinge Pin - Steering Handle.....
21-39	1	Washer - Hinge Pin Nut.....
21-44	2	Screw - Wrist Pin Locking.....
21-45	3	Screw - Flywheel Cover Plate.....
21-46	2	Pin - Clamp Screw Handle.....
21-47	6	Rivet - Quadrant to Stern Bracket.....
21-51	1	Bolt - Gearcase Head.....
21-55	1	Washer - Gearcase Head Bolt.....
21-59	1	Dowel Pin - Gearcase to Pinion Shaft Casing.....
21-62	1	Thrust Washer - Pinion Shaft.....
21-63	4	Plug - Driveshaft Casing - Pinion Shaft Casing - Gearcase.....
21-64	1	Plug - Inspection Hole - Gearcase.....
21-65	1	Gasket - Driveshaft Casing to Pinion Shaft Casing.....
21-66	2	Water Tube - Driveshaft Casing.....
21-68	1	Stud - Driveshaft Casing to Pinion Shaft Casing.....
21-82	2	Quadrant - Stern Bracket.....
21-88	1	Spline Coupling - Driveshaft.....
21-89	1	Coupling - Water Tube - Exhaust Pipe to Pinion Shaft Casing.....
21-92	2	Clamp Screw Only - Stern Bracket.....
21-94	2	Motor Rest - Muffler.....
21-97	2	Gasket - Muffler to Cylinder.....
21-98	8	Stud - Muffler.....
21-99	1	Gasket - Exhaust Pipe to Muffler.....
21-101	1	Cutout Plate - Muffler.....
21-102	1	Gasket - Cutout Plate.....
21-108	1	Lever - Relief Valve.....
21-110	1	Bushing - Relief Valve.....
21-113	2	Lever - Bypass Valve - Relief Valve.....
21-114	1	Spring - Relief Valve.....
21-116	1	Bearing - Bypass Valve.....
21-118	2	Stud - Muffler Eye Nut.....
21-120	2	Lockwasher - Pinion Shaft and Propeller Shaft Nuts.....
21-121	1	Washer - Inspection Hole Plug - Gearcase.....
21-122	4	Washer - Plug - Driveshaft Casing - Pinion Shaft Casing Gearcase.....
21-152	2	Clamp Screw - Bracket Steering Handle Hinge.....
21-153	8	Stud - Cylinder Head.....
21-154	8	Washer - Cylinder Head Stud.....
21-161	2	Water Tube - Driveshaft Casing (POL).....
21-163	1	Cotter Pin - Ratchet Lever Stud.....
21-165	1	Washer - Relief Valve.....
21-170	2	Studs - Crankcase Head to Crankcase - Short.....
21-173	1	Pin - Driveshaft Spline Coupling.....
21-174	4	Core Plug - Muffler - Small.....
21-177	1	Pin - Ratchet Lever.....
21-178	1	Spring - Ratchet Lever.....
21-187	2	Stud - Crankcase Head to Crankcase - Long.....
21-189	4	Stud - Power Head to Lower Unit.....
21-190	1	Gasket - Bypass Valve Cap.....
21-191	2	Dowel Pin - Cylinder Head.....
21-198	2	Key - Crankshaft.....
21-202	2	Screw - Gas Tank to Cylinder.....

\*These parts used on model PO-15 motor equipped with exhaust cutout assembly.

**Order All Parts from Nearest Dealer or Service Station**



**Always Give Part Number and Motor Number**  
**PARTS FOR PO-15—Cont.**

Part No.	No. Required per Motor	NAME OF PART
21-212	1	Spring - Bypass Valve.....
21-213	1	Washer - Bypass Valve.....
21-222	1	Spring - Relief Valve.....
21-230	2	Core Plug - Muffler Large.....
21-283	4	Screw - Carburetor Panel.....
21-344	1	Nut - Tilting Shaft.....
21-349	2	Handle - Stern Bracket - Clamp Screw.....
21-352	1	Bracket - Relief Valve.....
21-354	1	Bushing - Relief Valve Bracket.....
21-355	1	Bushing - Relief Valve Handle.....
21-356	1	Shaft - Relief Valve Handle.....
*21-358	4	Screw - Cutout to Exhaust Pipe.....
*21-359	2	Screw - Exhaust Cutout Cap.....
21-360	1	Groove Pin - Relief Valve Handle.....
21-373	1	Spring - Stop Switch.....
21-374	1	Cap - Steering Handle.....
21-375	1	Grip - Steering Handle.....
21-376	1	Hinge Pin - Steering Handle.....
21-379	1	Washer - Stop Button - Return.....
21-380	1	Washer - Steering Handle Cap.....
21-381	2	Thrust Washer - Hinge Pin.....
21-396	1	Bracket - Ratchet Lever.....
21-397	1	Stud - Ratchet Lever.....
21-398	1	Nut - Ratchet Lever Stud.....
21-428	1	Attachment Plug Body.....
21-431	1	Journal Bearing - Lower.....
21-434	1	Oil Slinger - Crankshaft.....
21-435	1	Cover Plate - Flywheel.....
21-448	2	Thrust Washer - Swivel Bracket to Stern Bracket.....
21-457	2	Clip - Carburetor Drain Pipe.....
21-475	1	Nut - Driveshaft Casing to Pinion Shaft Casing Stud.....
21-484	1	Clip - Carburetor Control Cable.....
21-553	1	Straight Fitting - Gas Line to Carburetor.....
21-592	2	Washer - Pinion Shaft and Propeller Shaft Nut.....
21-594	1	Transfer - Starting.....
**21-595	1	Transfer - Oiling.....
21-601	5	Screw - Swivel Bracket - Steering Handle to Cylinder.....
22-15	1	Driveshaft & Coupling Assembly.....
22-40	1	Driveshaft and Coupling Assembly (POL).....
22-44	1	Shut-off Valve and Screen Assembly - Gas Tank.....
22-65	1	Stern Bracket Assembly (With Quadrants Only).....
22-78	1	Swivel Bracket.....
22-92	1	Water Tube - Outlet - Star.....
22-93	1	Water Tube - Outlet - Port.....
22-137	1	Relief Valve Lever and Shaft Assembly.....
22-139	2	Clamp Screw and Handle Assembly for Stern Bracket.....
22-140	1	Push Button Assembly - Steering Handle Cap.....
22-145	1	Ratchet Lever and Finger Assembly.....
22-165	1	Tilting Shaft Assembly.....
22-204	1	Relief Valve Complete.....
23-46	1	Pinion Shaft.....
23-53	1	Nut - Propeller.....
23-57	2	Stud - Gearcase to Driveshaft Casing.....
23-58	1	Gasket - Gearcase to Pinion Shaft Casing.....
23-61	1	Bearing - Pinion Shaft Casing - Upper.....
23-63	1	Handle - Relief Valve Handle.....
23-77	1	Pinion Shaft Casing only - Less Bearings.....
23-194	2	Gasket - Fuel Passage Screw.....
23-232	2	Screw - Fuel Passage.....
§23-282	1	Cork Packing - Propeller Shaft Bushing.....
23-284	1	Bushing - Propeller Shaft - Propeller End.....
24-22	1	Pinion Shaft Casing Only - With Bearings.....
24-52	1	Ball Bearing - Pinion Shaft.....
24-107	1	Lower Unit - Less Propeller.....
24-108	1	Lower Unit - Less Propeller (POL).....

\*These parts used on model PO-15 motor equipped with exhaust cutout assembly.

\*\*Used on model PO-15 motors below serial number 698875.

§These parts used on model PO-15 motor equipped with old style propeller shaft bushing.

**Order All Parts from Nearest Dealer or Service Station**



**Always Give Part Number and Motor Number**

**PARTS FOR PO-15—Cont.**

Part No.	No. Required per Motor	NAME OF PART
24-135	1	Gearcase and Pinion Shaft Casings Complete With Shaft and Gears.....
24-207	1	Gearcase and Pinion Shaft Casing assembly, Less Gears and Shafts.....
25-28	2	Stud - Carburetor to Crankcase.....
29-10	6	Piston Rings.....
29-11	2	Wrist Pin - Piston.....
29-12	2	Bushing - Wrist Pin - Connecting Rod.....
29-13	1	Bypass Valve.....
29-15	2	Gasket - Cylinder Base.....
29-16	1	Relief valve.....
29-21	1	Rod - Bypass Valve to Relief Valve.....
*29-24	1	Body - Exhaust Cutout.....
*29-25	1	Plunger - Exhaust Cutout.....
*29-26	1	Retaining Ring - Exhaust Cutout.....
*29-27	1	Cap - Exhaust Cutout.....
*29-28	1	Gasket - Exhaust Cutout Cap.....
*29-29	1	Spring - Exhaust Cutout Plunger.....
*29-30	1	Gasket - Exhaust Cutout to Exhaust Pipe.....
29-51	2	Gasket - Cylinder Head.....
29-151	1	Transfer - Gasoline Tank.....
29-155	24	Rollers - Connecting Rod Bearings.....
29-156	2	Retainer - Connecting Rod Rollers.....
29-157	1	Cylinder Head - Star.....
29-158	1	Cylinder Head - Port.....
29-159	1	Journal Bearing - Upper.....
29-162	1	Gasket - Carburetor to Crankcase.....
29-165	1	Crankshaft.....
29-167	1	Panel - Carburetor.....
29-168	1	Clampscrew - Bowden Cable.....
29-169	1	Hinge - Steering Handle.....
29-170	1	Gasket - Carburetor Panel.....
29-177	8	Stud - Cylinder to Crankcase.....
29-178	4	Screw - Connecting Rod.....
29-179	1	Rubber Base - Steering Handle.....
29-180	1	Spring Clip - Driveshaft Casing Water Tubes.....
29-181	1	Stud - Propeller Shaft.....
29-196	1	Carburetor Body.....
29-201	2	Spray Guard.....
29-203	1	Bushing - Steering Handle.....
20-204	1	Tube - Inner - Steering Handle.....
29-205	1	Tube - Control Handle - Outer.....
29-208	1	Lever - Steering Handle.....
29-209	1	Control Handle - Steering Handle.....
30-9	1	Exhaust Pipe.....
30-10	1	Exhaust Pipe (POL).....
30-16	1	Tool Kit.....
30-18	2	Water Tube - Inlet - Star and Port.....
30-23	1	Cylinder - Star.....
30-24	1	Cylinder - Port.....
* 30-25	1	Exhaust Cutout Assembly.....
30-63	1	Gasoline Line.....
30-113	1	Control Cable - Carburetor.....
30-115	2	Connecting Rod Assembly.....
30-116	1	Muffler Assembly Complete.....
30-117	1	Carburetor Complete.....
30-119	1	Piston and Connecting Rod Assembly.....
30-120	1	Cylinder Head and Relief Valve - Port.....
**30-121	1	Gasoline Tank - With Transfers.....
30-122	1	Crankcase and Crankcase Head Complete with Bearings.....
30-131	1	Oil Line - Inlet.....
30-134	1	Driveshaft Casing.....
30-143	1	Driveshaft Casing (POL).....
30-146	1	Contact Block and Lead Assembly - Steering Handle.....
30-147	1	Grip and Tube Assembly - Steering Handle.....
31-159	1	Groove Pin - Bearing Retainer.....

\*These parts used on model PO-15 motor equipped with exhaust cutout assembly.

\*\*These parts used on model PO-15 motors below serial 698875.

**Order All Parts from Nearest Dealer or Service Station**



Always Give Part Number and Motor Number

**PARTS FOR PO-15—Cont.**

Part No.	No. Required per Motor	NAME OF PART
35-97	1	Float .....
35-99	1	Strainer Housing .....
35-100	1	Strainer Screen Assembly.....
35-101	1	Retaining Screw - Strainer Housing.....
35-102	1	Gasket - Strainer.....
35-103	1	Gasket - Strainer Screw.....
35-104	2	Plug - Fuel Passage.....
35-107	1	Thrust Washer.....
35-108	2	Gasket - Fuel Passage Plug.....
35-110	1	Float Clip.....
35-114	5	Screw - Cover.....
35-116	1	Lockwasher - Choke Lever Screw.....
37-108	3	Retainer Washer - Steering Handle to Cylinder Screws..
37-109	3	Rubber Washer - Steering Handle to Cylinder Screws...
41-37	4	Screw - Spark Plug Cover.....
41-150	1	Pin - Journal Bearing to Crankcase Head.....
41-316	9	Lockwasher - Cylinder Base Stud - Driveshaft Casing to Pinion Shaft Casing.....
41-338	4	Lockwasher - Spark Plug Cover Screw.....
43-128	1	Feeler Gauge.....
51-47	2	Screw - Ratchet Lever Bracket.....
51-194	2	Pipe Plug - Port and Star Cylinder.....
71-31	1	Screw - Breaker Mounting.....
71-45	4	Screw - Throttle Plate - Terminal, Spring Mounting....
71-49	1	Washer - Contact Screw.....
71-60	1	Terminal - Cutout Lead.....
71-66	2	Insulation Washer - Contact Screw.....
71-471	2	Hexnut - Screw on Terminal - Contact Point.....
71-765	3	Screw - Quadrant.....
71-870	1	Plug - Insulator for Cutout Wire - Steering Handle....
71-872	1	Packing Washer - Cutout Wire Insulation Plug.....
71-915	9	Lockwasher - Lever Clampscrew - Coil Mounting Screw
71-918	2	Lockwasher - Breaker Terminal.....
71-939	4	Screw - Coil Mounting.....
71-940	2	Screw - Coil Heel.....
71-1048	2	Washer - Breaker Post.....
71-1052	1	Clip Spring - Breaker Post.....
71-1054	3	Drive Screw - Mounting Cam.....
71-1102	2	Nut - Carburetor Drain Clampscrew.....
71-1111	1	Tubing - Insulation - Cutout Lead.....
71-1126	1	Cam.....
71-1128	1	Breaker Post.....
71-1139	1	Timing Lever .....
71-1146	1	Point - Screw - Contact.....
71-1147	1	Plate - Breaker.....
71-1148	1	Bushing - Insulation.....
71-1223	1	Quadrant.....
71-1235	1	Screw - Armature Plate Clamp.....
71-1244	1	Plug - Attachment.....
71-1249	1	Armor - Cutout Lead.....
71-1261	1	Clip - Cutout Lead.....
71-1268	1	Clip - Cutout Lead Armor.....
71-1274	1	Locknut - Contact Screw.....
71-1308	2	Swivel - Control Cable at Steering Handle - Carburetor Control .....
71-1311	1	Screw - Gas Tank Support.....
71-1369	1	Felt Pad - Condenser Pocket.....
71-1420	2	Grommet - Ignition Lead.....
72-735	1	Breaker Arm Assembly.....
72-781	1	Breaker Plate and Point Assembly.....
72-852	1	Coil Assembly (Less Leads).....
72-855	1	Heel Assembly - Right Hand.....
72-856	1	Heel Assembly - Left Hand.....
72-858	1	Armature Plate and Clampscrew Only.....
72-859	1	Armature Plate Assembly Complete.....
72-860	1	Magneto Complete.....

Order All Parts from Nearest Dealer or Service Station

**Always Give Part Number and Motor Number**

**PARTS FOR PO-15—Cont.**

Part No.	No. Required per Motor	NAME OF PART
72-861	1	Dome Assembly.....
72-864	1	Condenser Complete.....
72-883	1	Cutout Lead Assembly.....
76-131	2	Spark Plug.....
76-143	1	Steering Handle Complete.....
85-63	4	Screw - Cutout Plate to Muffler.....
85-64	4	Check Nut - Throttle Adjustment Screw - Ball Joint Relief Valve.....
121019	4	Lockring - Spark Plug Cover Screw.....
201446	1	Terminal - Breaker.....
300316	1	Ball Bearing - Propeller Shaft.....
300352	1	Gearcase Head.....
300353	1	Retainer - Propeller Thrust Bearing.....
300354	1	Locknut - Gearcase Head.....
300359	1	Gasket - Gearcase Head.....
300398	As	Shim - Crankcase Head to Crankcase.....
300782	1	Drain Pipe - Carburetor Intake Manifold.....
300783	1	Drain Pipe - Carburetor Air Passage.....
300789	1	Cover - Carburetor.....
300790	1	Lever - Throttle.....
300791	1	Shaft - Throttle.....
300792	1	Lever - Choke.....
300793	1	Gasket - Cover.....
300794	2	Venturi Tube.....
300795	1	Plate Assembly - Choke.....
300796	1	Needle Valve - Slow Speed.....
300797	1	Needle Valve - High Speed.....
300798	1	Pivot Plug - Choke Lever.....
300799	1	Shaft - Choke.....
300800	1	Float Valve.....
300801	1	Gasket - Choke Lever.....
300802	2	Gasket - Venturi Tube.....
300803	1	Thrust Washer - Choke.....
300804	1	Spring - Choke Lever.....
300805	1	Plate - Throttle.....
300808	2	Expansion Plug.....
300809	1	Screw - Choke Lever.....
300810	1	Clampscrow - Throttle Lever.....
300811	1	Screw - Throttle Adjustment.....
301418	1	Bow Washer - Breaker.....
301419	1	Adjustable Lever - Breaker.....
301991	1	Grease Seal - Propeller Shaft.....
302185	1	Screw - Carburetor Control Clip.....
‡‡ 302241	1	Transfer - Oiling.....
302289	1	Key - Propeller Shaft.....
375003	1	Thrust Socket Bolt Assembly.....
375083	1	Propeller Shaft & Key Assembly.....
375119	1	Crankcase Head and Bearing Assembly.....
375172	1	Crankcase and Bearing Assembly.....
375295	2	Terminal Assembly - High Tension Lead.....
375344	2	Piston and Dowel Pin Assembly.....
§ 375428	1	Cap Assembly - Propeller Shaft Bushing.....
375514	1	Filler Cap Assembly - Gasoline Tank.....
375541	1	Spark Plug Cover Assembly.....
375543	1	Gear Assembly.....
375561	2	Ignition Lead Assembly - High Tension.....
375581	1	Propeller.....
375604	1	Gearcase and Bushing Assembly.....
‡‡ 375664	1	Gasoline Tank With Transfers.....

‡‡Used on model PO-15 motors above serial number 698874.

§These parts used on model PO-15 motor equipped with old style propeller shaft bushing.

**Order All Parts from Nearest Dealer or Service Station**