

Western Auto Stock Number: 2G6608
Factory Model Number: WF-4
Year Model: 1949-50
Western Auto Stock Number: 2G6609
Factory Model Number: WG-4
Year Model: 1951-53

MODELS WF-4 and WG-4

Manual No. 80-06



**MODELS WF-4 and WG-4
6 H.P. SPECIFICATION**

- . 6 Horsepower at 4000 R.P.M.
- . Twin Alternate Firing Cylinders,
2" Bore x 1 3/4" stroke
- . Piston Displacement, 11 cu. in.
- . Gas Tank Capacity, 7 Pints
- . Spark Plugs, Champion J8J,
.030" Gap
- . Magneto Breaker Point Gap *
- . Transom Height, 15"
- . Weight - 49 Pounds

FEATURES

- . Robot - Rewind Starter
- . Ignition, Waterproof High
Voltage Magneto
- . Carburetor, Tillotson Automotive Type
- . Airplane Type Fuel Filter
- . Automatically Timed Reed Valves
- . Roller Type Bearings
- . Adjustable Co-Pilot
- . Full Pivot Reverse
- . Non-Clog, 6 Vane, Rubber Water Pump Impeller
- . Clutch, Duo-Flex Friction
Release Type

REVISED MAY 1953

* New Points .020 - After Using 15 Hours Reset to .018

(6 H.P. Section)

No. 80-06

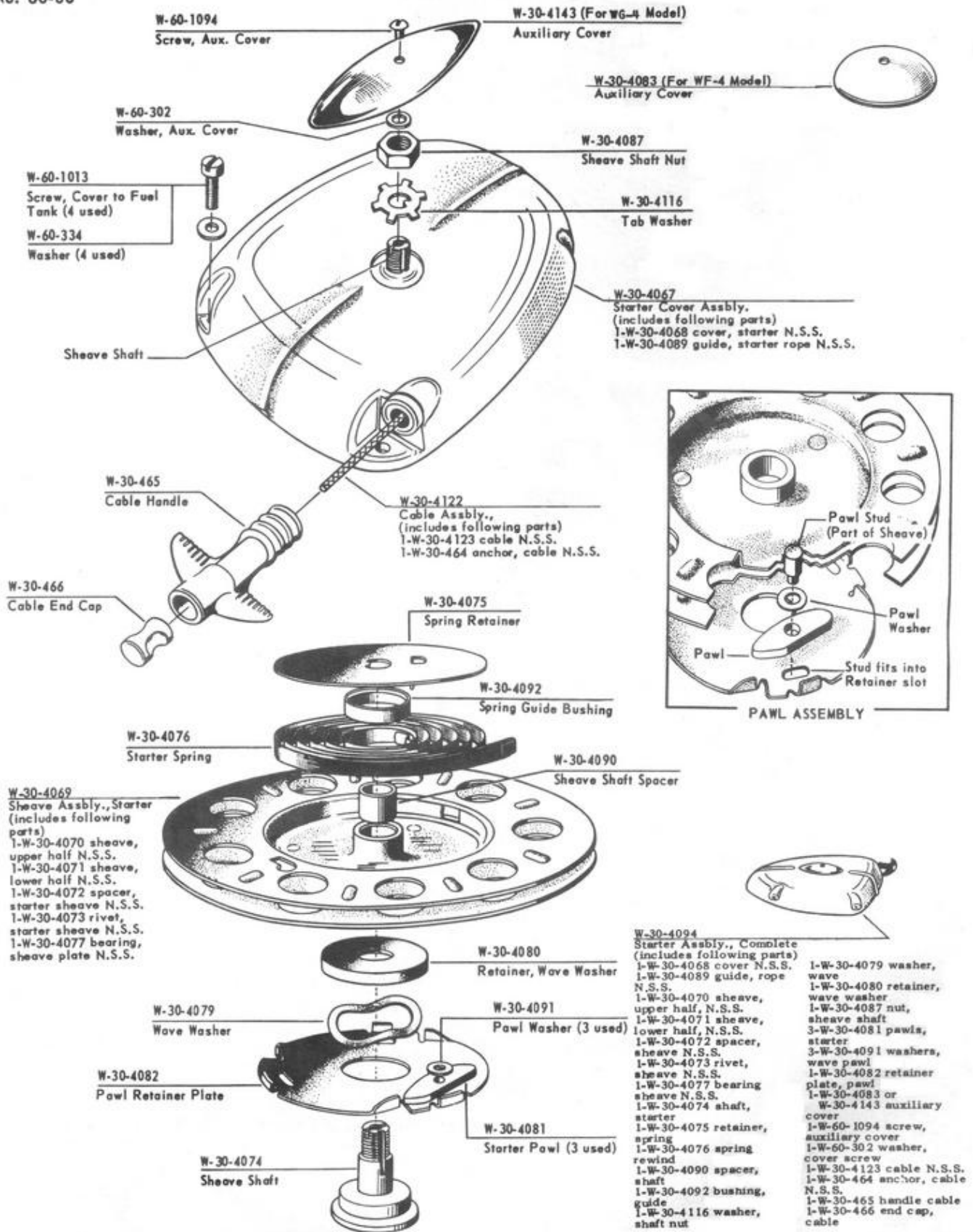

6

(6 H.P. Section)

REVISED MAY 1953

FUEL TANK, FUEL FILTER AND COWL ASSEMBLIES

MODELS WF-4 and WG-4

No. 80-06

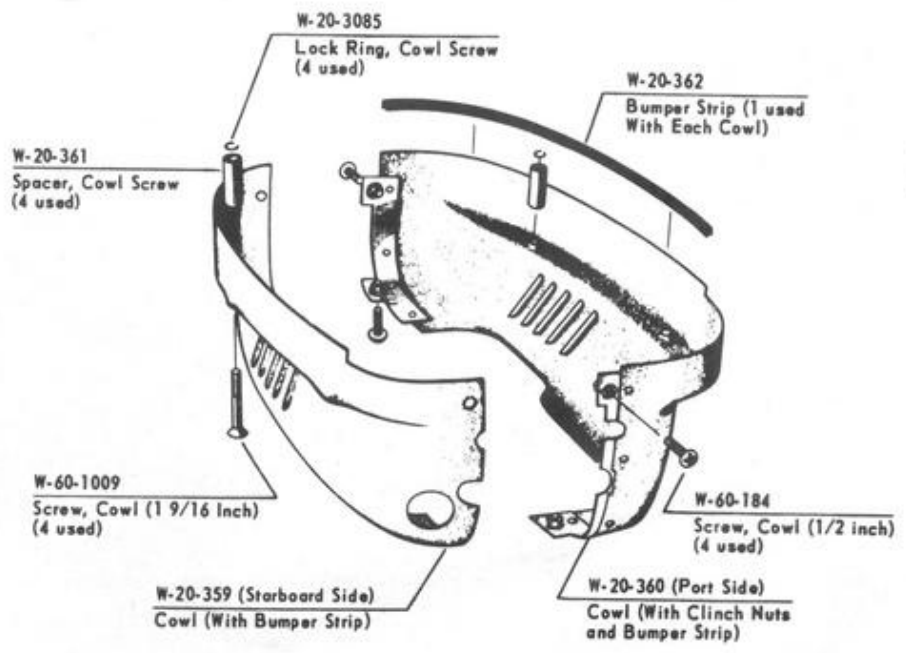
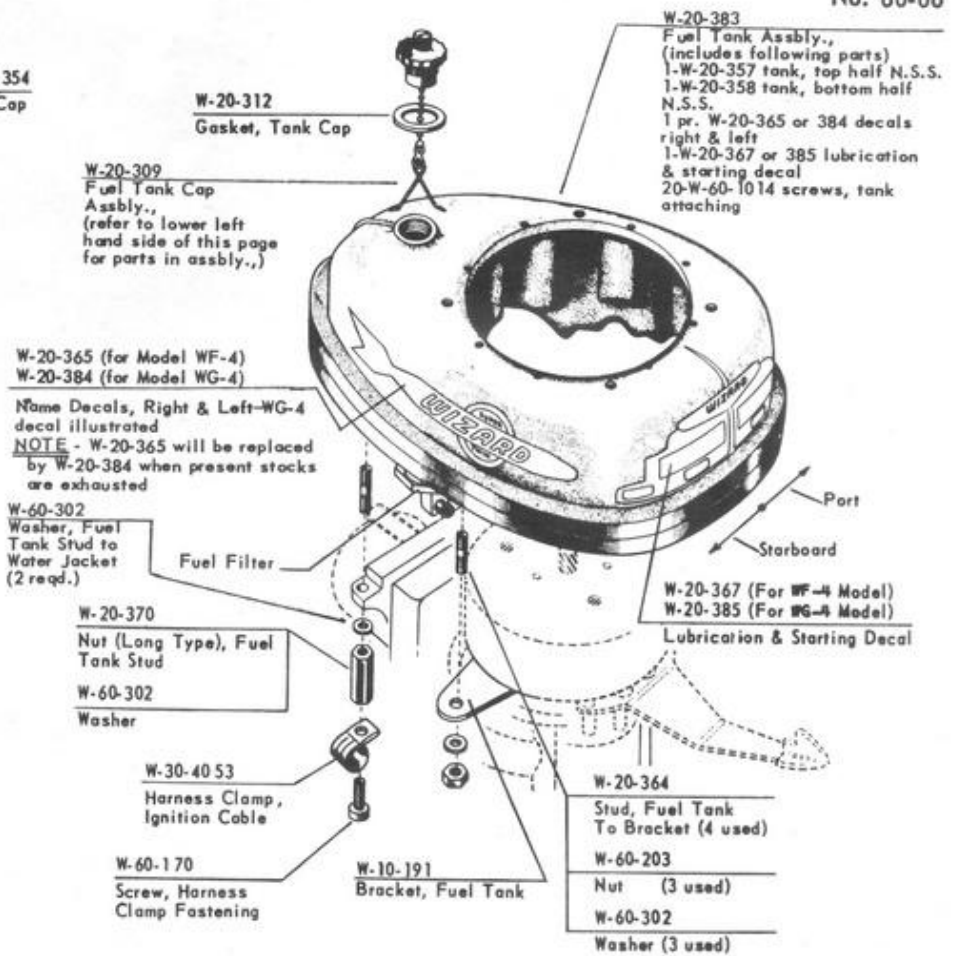
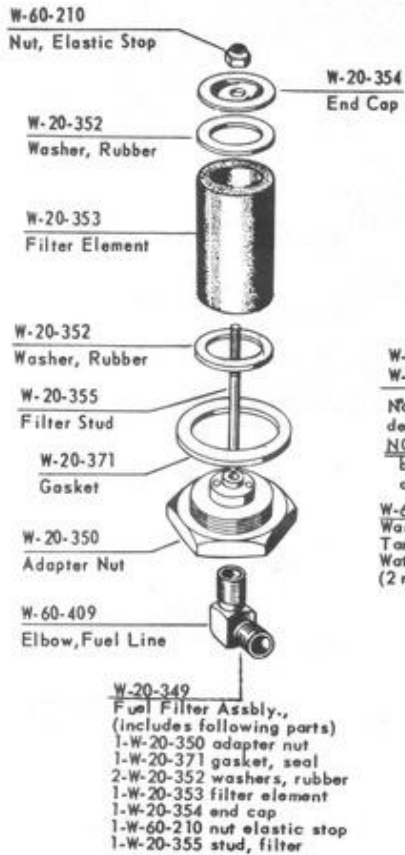

6

No. 80-06

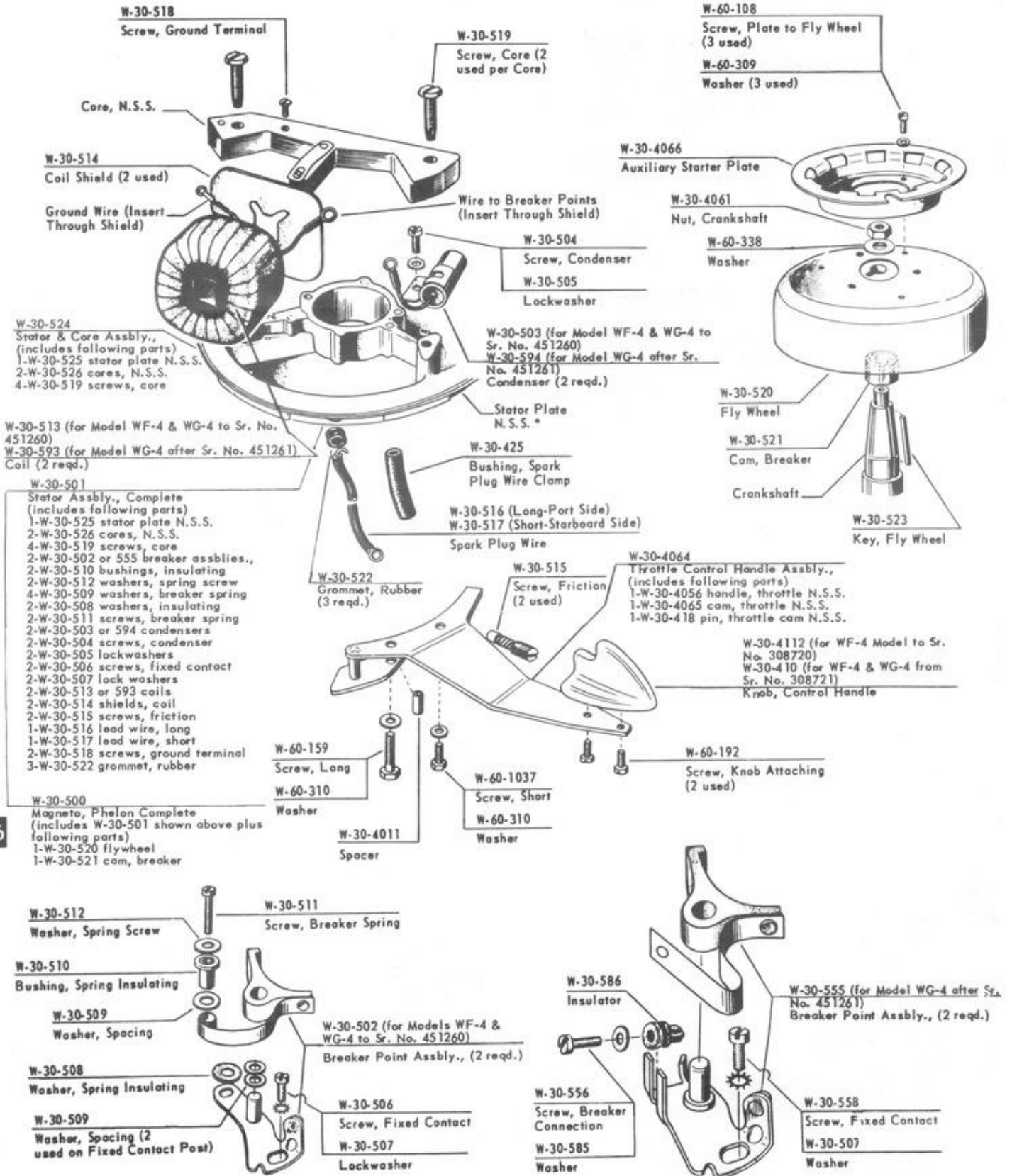

(6 H.P. Section)

REVISED MAY 1953

CARBURETOR & FUEL SHUT-OFF VALVE ASSEMBLIES

MODELS WF-4 and WG-4

No. 80-06

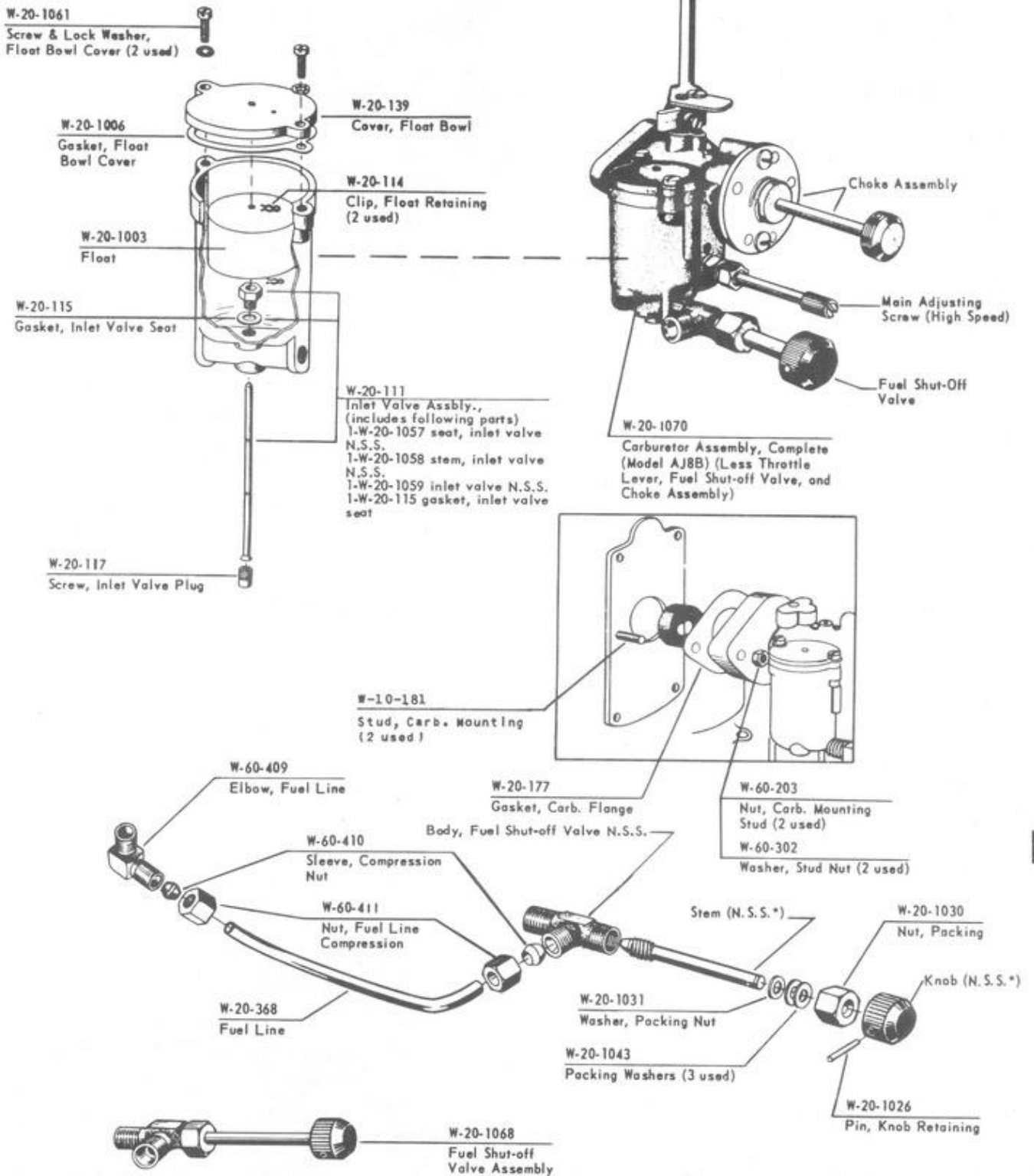

6

REVISED MAY 1953

(6 H.P. Section)

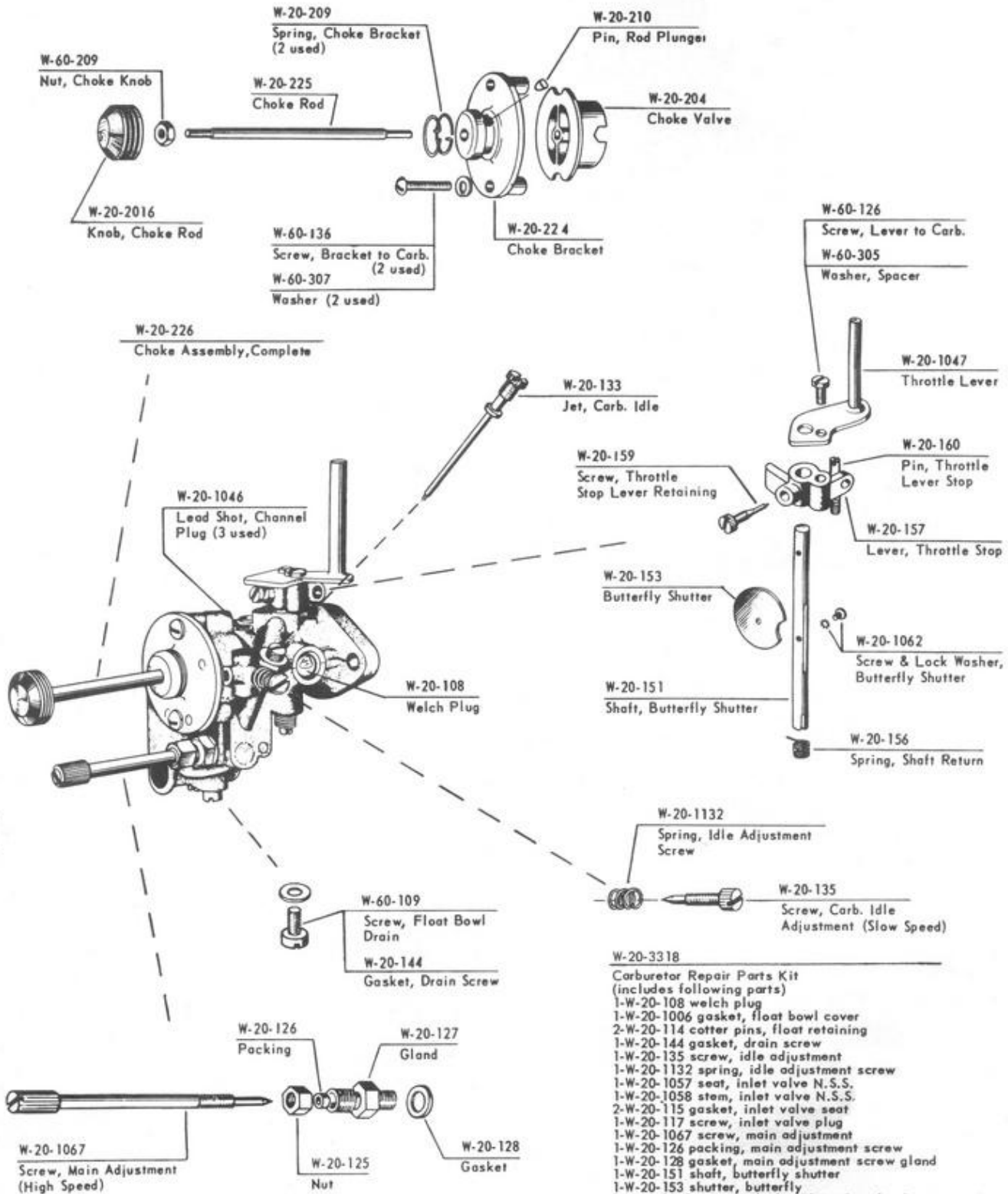

(6 H.P. Section)

CYLINDER, WATER JACKET & EXHAUST MANIFOLD ASSEMBLIES

MODELS WF-4 and WG-4

No. 80-06

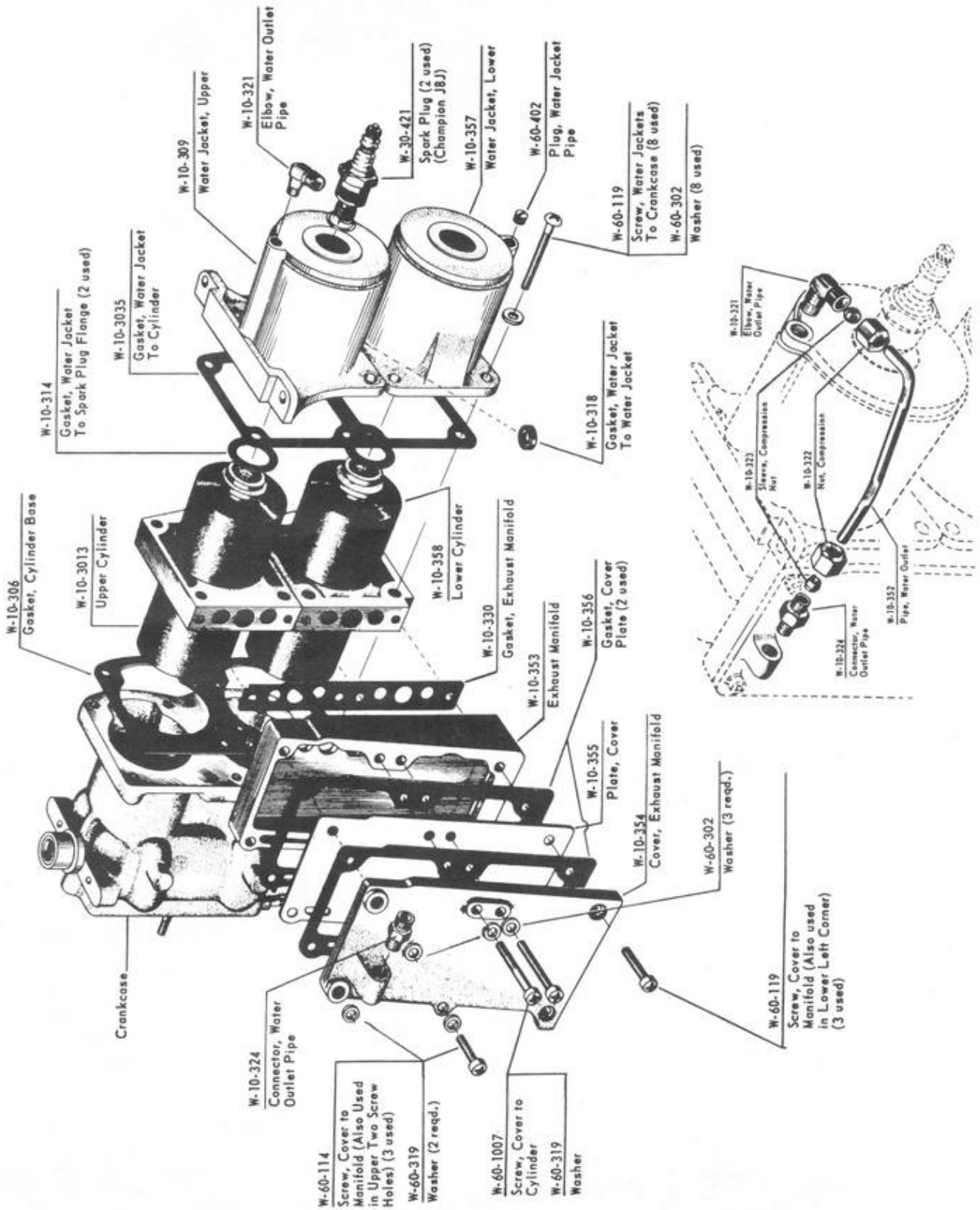

No. 80-06

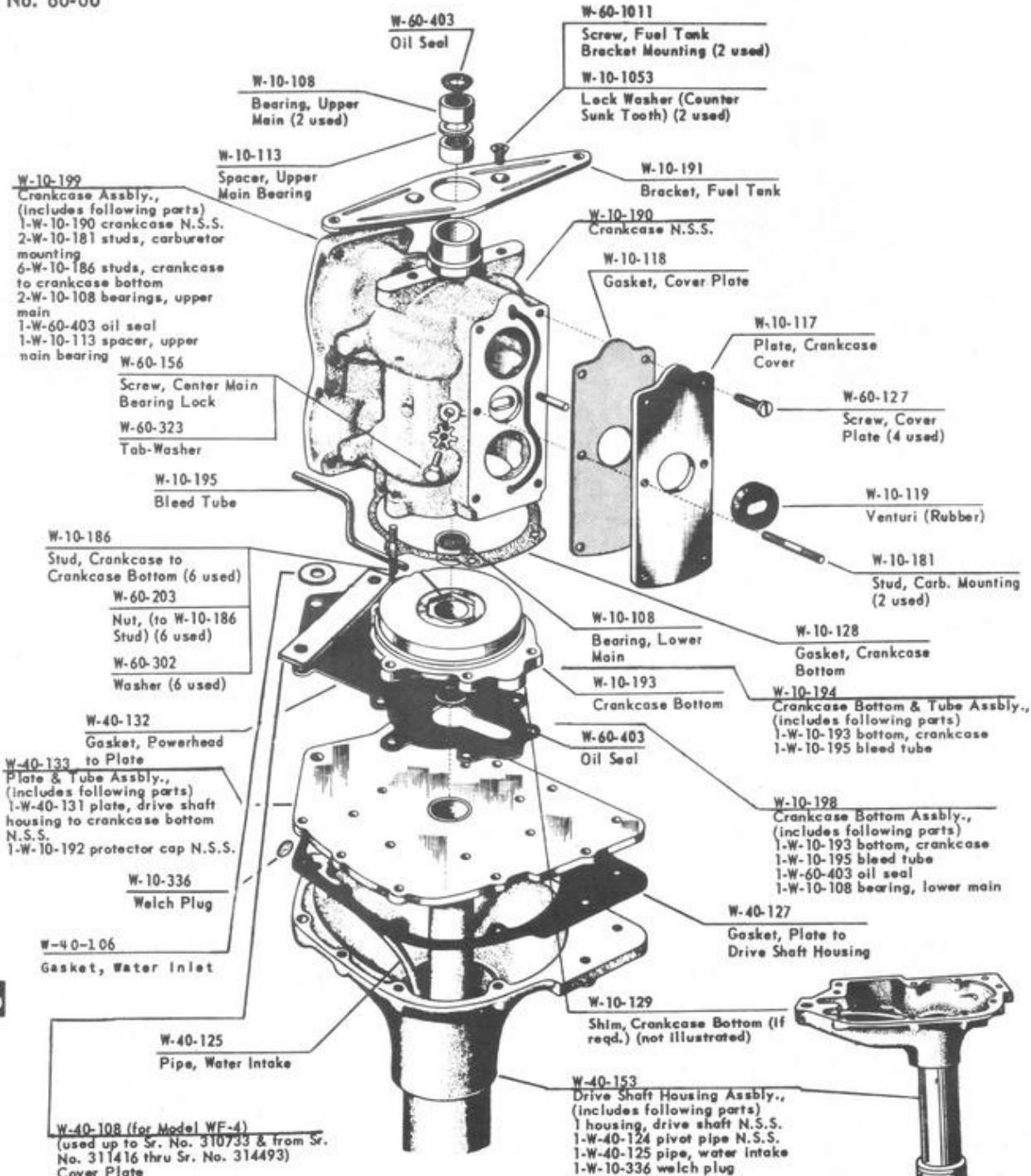

- W-60-5025**
Gasket Set (includes following gaskets)
1-W-10-128 crankcase bottom
1-W-10-118 crankcase cover plate
1-W-10-306 cylinder base
1-W-10-3035 water jacket to cylinder
1-W-10-318 water jacket to water jacket
2-W-10-314 water jacket to spark plug flange
1-W-10-330 exhaust manifold
2-W-30-356 cover plate
1-W-20-177 carburetor flange
1-W-20-312 filler cap
1-W-40-127 plate to drive shaft housing
1-W-40-106 water inlet
1-W-40-132 powerhead to plate
1-W-50-122 pump to gear housing

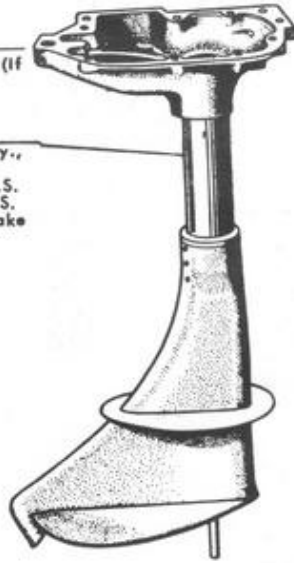

6

CRANKSHAFT, ROD, PISTON & CENTER MAIN BEARING ASSEMBLIES

MODELS WF-4 and WG-4

No. 80-06

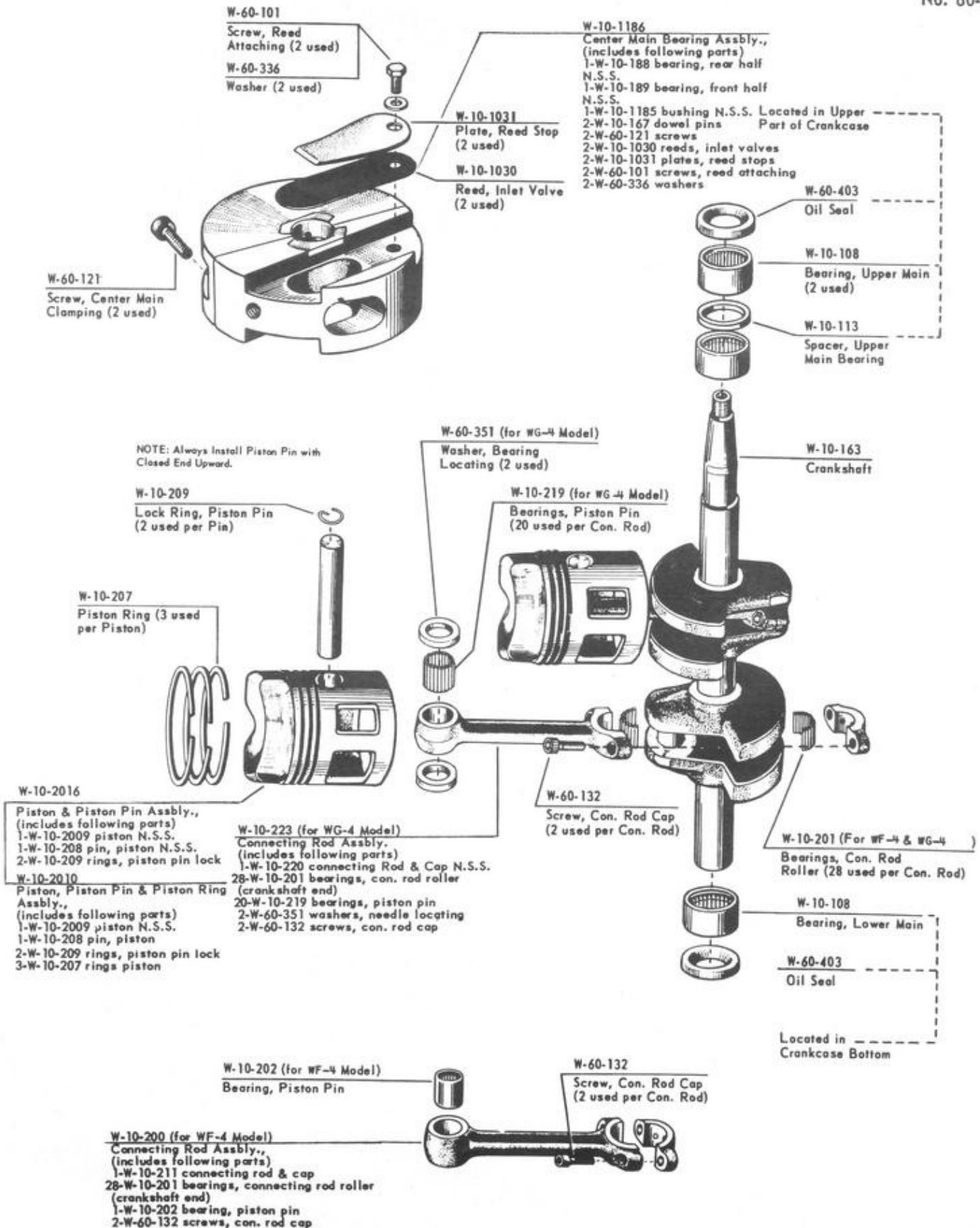

REVISED MAY 1953

(6 H.P. Section)

CLAMPING BRACKET, Co-Pilot & SWIVEL BRACKET ASSEMBLIES

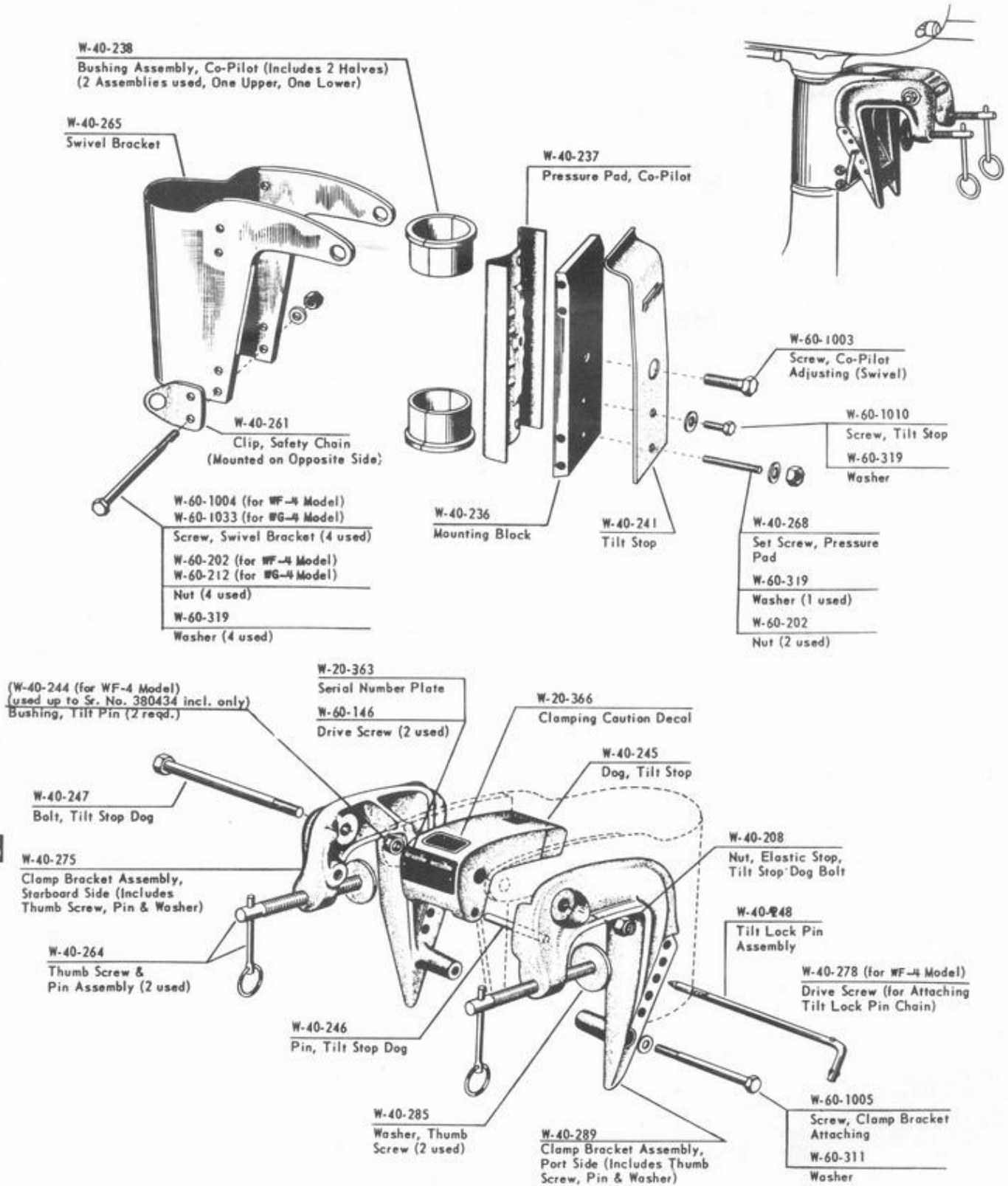

6

STEERING HANDLE ASSEMBLY

MODELS WF-4 and WG-4

No. 80-06

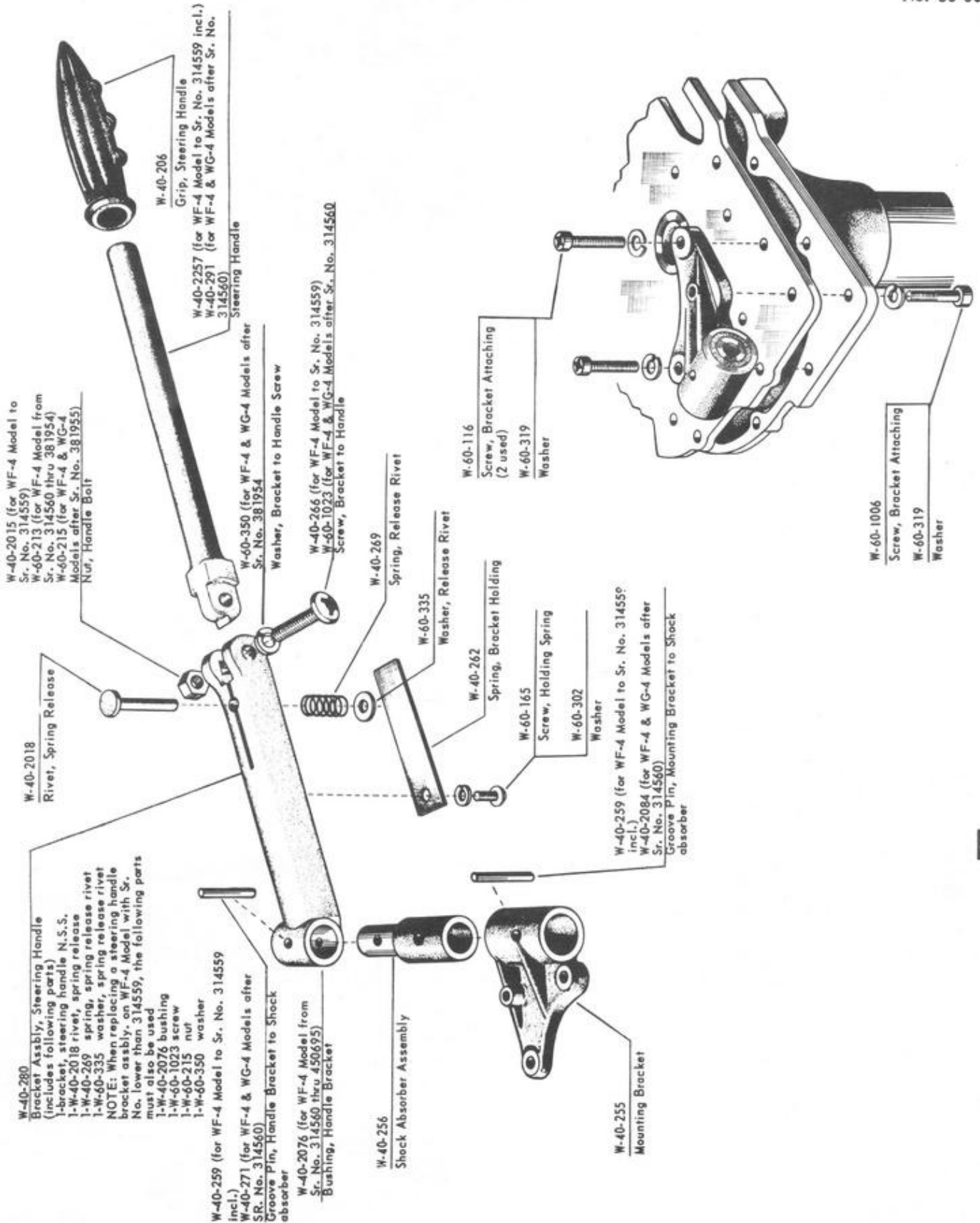

REVISED MAY 1953

(6 H.P. Section)

GEAR, GEAR HOUSING, DRIVE SHAFT, WATER PUMP & PROPELLER SHAFT ASSEMBLIES

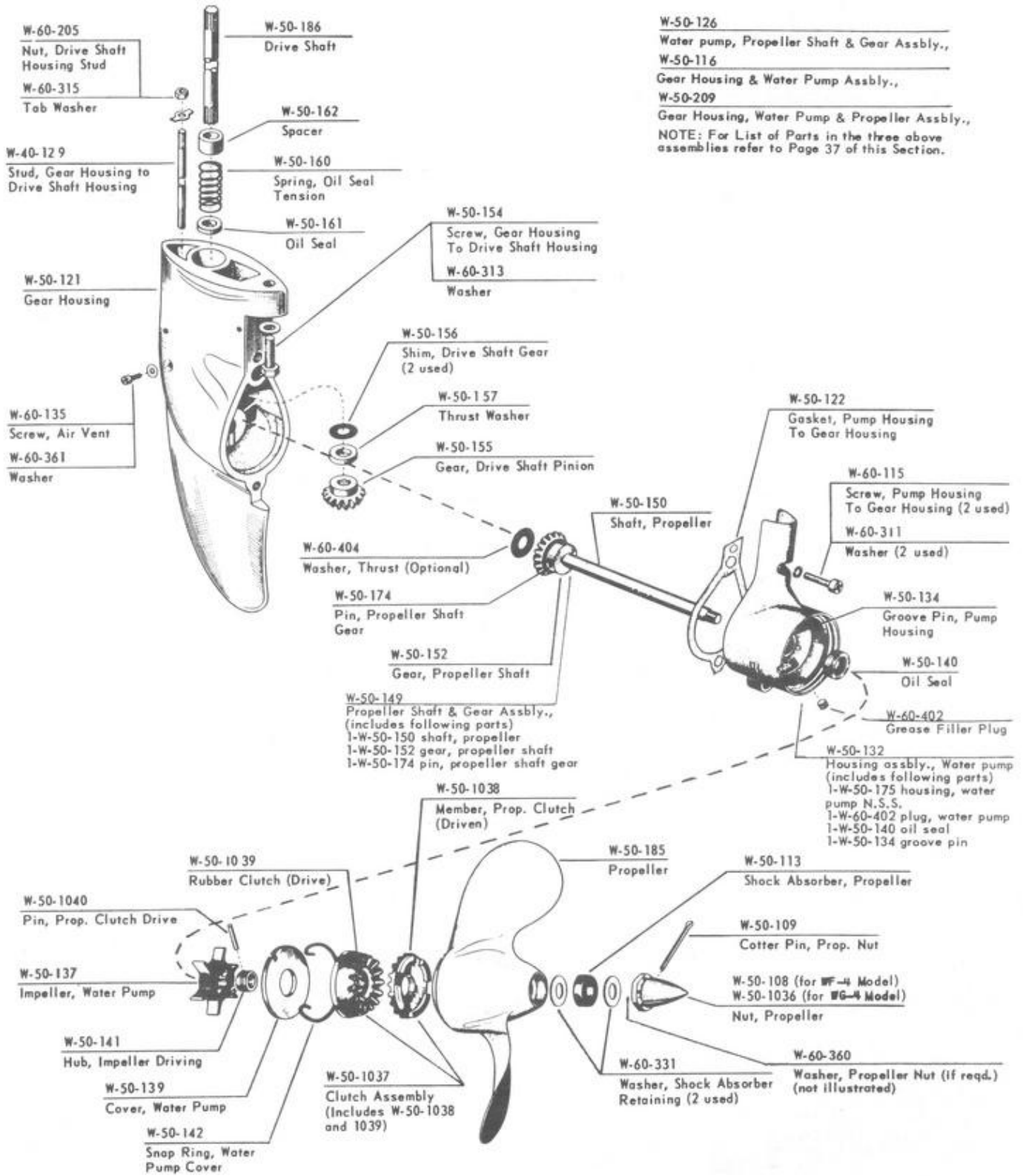

6

CARRYING HANDLE, DRIVE SHAFT HOUSING
 PLATE, GEAR HOUSING, WATER PUMP
 PROPELLER & GEAR ASSEMBLIES

MODELS WF-4 and WG-4

No. 80-06

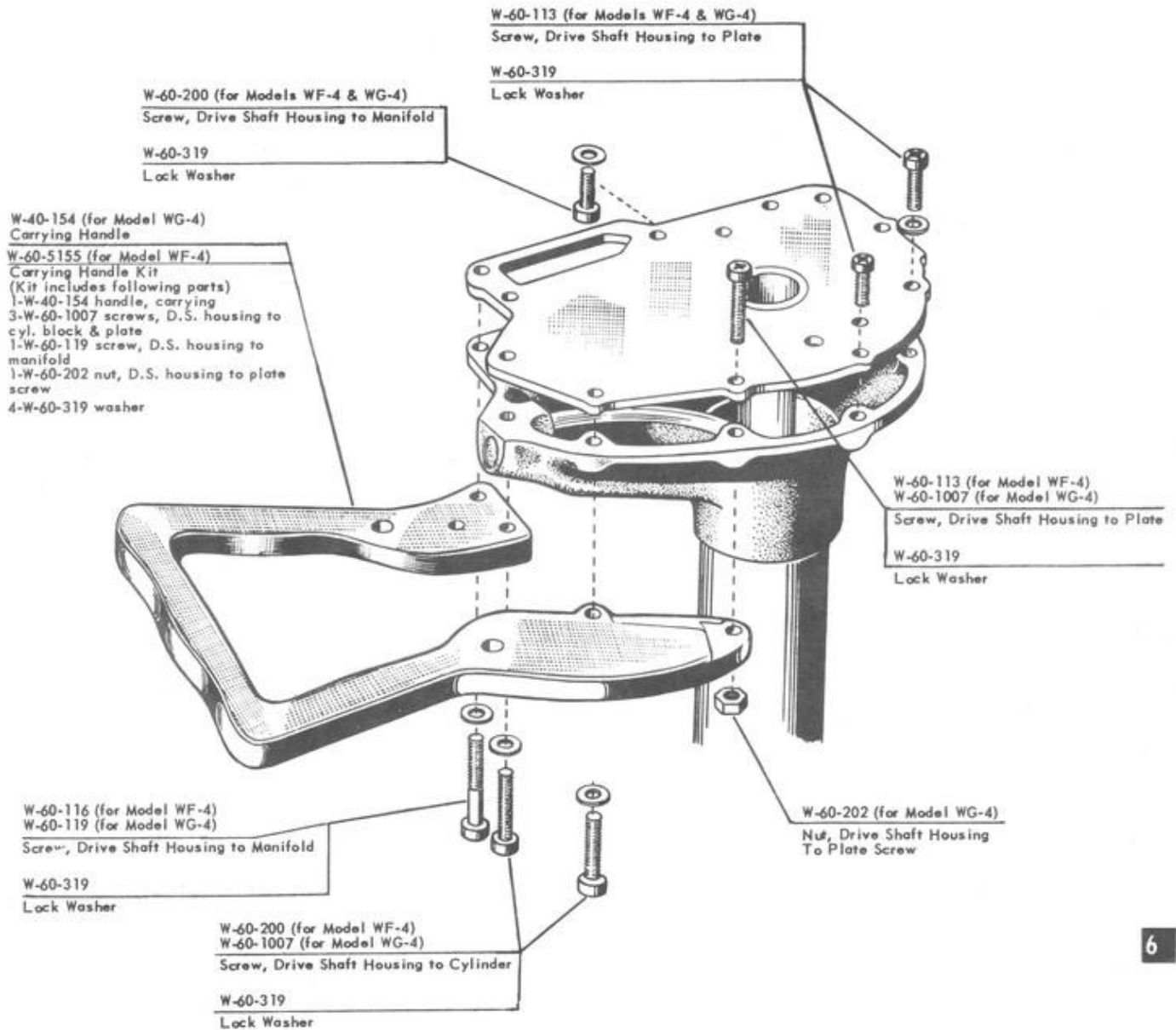

6

- W-50-209
 Gear Housing, Water Pump & Propeller Assemblies
 (includes W-50-116 shown in middle column plus
 following parts)
 1-W-50-1038 member, propeller clutch (driven)
 1-W-50-1039 rubber clutch (drive)
 1-W-50-185 propeller
 1-W-50-108 or 1036 nut, propeller
 1-W-60-360 washer, propeller nut (if reqd.)
 1-W-50-109 pin, cotter-propeller nut
 1-W-50-113 shock absorber, propeller
 2-W-60-331 washers, shock absorber retaining

- W-50-116
 Gear Housing & Water Pump assemblies
 (includes W-50-126 shown in right hand
 column plus following parts)
 1-W-50-121 gear housing
 2-inserts N.S.S.
 1-W-50-122 gasket, water pump
 2-W-60-115 screws, water pump
 2-W-60-311 washer, water pump
 1-W-60-135 screw, gear housing vent
 1-W-60-361 washer, gear housing
 1-W-50-161 oil seal
 1-W-50-162 spacer
 1-W-50-160 spring, oil seal tension
 1-W-50-154 screw, gear housing
 1-W-60-313 washer, gear housing
 1-W-40-129 stud, gear housing

- W-50-126
 Water Pump, Propeller Shaft & Gear Assbly.,
 (includes following parts)
 1-W-50-175 housing, water pump N.S.S.
 1-W-60-402 plug, water pump
 1-W-50-140 oil seal
 1-W-50-134 pin, pump housing
 1-W-50-137 impeller, pump
 1-W-50-142 snap ring, pump
 1-W-50-150 shaft, propeller
 1-W-50-152 gear, propeller shaft
 1-W-50-174 pin, propeller shaft gear
 1-W-60-404 washer, thrust (if reqd.)
 1-W-50-1040 pin, clutch drive
 1-W-50-155 gear, drive shaft pinion
 2-W-50-156 shims, drive shaft gear
 1-W-50-157 thrust washer
 1-W-50-141 hub, impeller driving
 1-W-50-139 cover, water pump

YEAR	MODEL IDENTIFICATION	SERIAL NUMBER RANGE	# of CYL
1941	WA-2	U/A	1
1941	WA-3	U/A	1
1941	WA-6	U/A	2
1942	WB-2	U/A	1
1942	WB-3	U/A	1
1942	WB-4	U/A	2
1942	WB-6	U/A	2
1946	WD-3 (STANDARD SINGLE)	U/A	1
1946	WD-4 (STANDARD TWIN)	U/A	2
1947	WD-3S (DELUXE SINGLE)	U/A	1
1947	WD-4S (DELUXE TWIN)	U/A	2
1948	WD-3S (DELUXE SINGLE)	U/A	1
1948	WD-4S (DELUXE TWIN)	U/A	2
1949	WF-4 (SUPER TWIN)	304554-319553	2
1950	WF-4 (SUPER TWIN)	379652-387685	2
1950	WF-7 (SUPER TEN)	408293-413300	2
1951	WG-4 (SUPER TWIN)	450696-458195	2
1951	WG-7 (SUPER TEN)	458196-465695	2
1952	WG-4 (SUPER TWIN)	507512-517511	2
1952	WG-7 (SUPER TEN)	497762-499261	2
1952	WG-7 (SUPER TEN)	534913-535012	2
1952	WH-7 (POWERMATIC 10)	521403-525402	2
1953	WG-4 (SUPER TWIN)	548763-557588	2
1953	WG-4 (SUPER TWIN)	572128-574127	2
1953	WG-7 (SUPER TEN)	564118-568117	2
1953	WG-7A (SUPER TEN)	591628-593627	2
1953	WH-7 (POWERMATIC 10)	568118-572117	2
1954	WG-4 (SUPER TWIN)	719088-733087	2
1954	WJ-7 (SUPER TEN)	733088-740087	2
1954	WK-7 (POWERMATIC 12)	740088-748087	2
1955	WH-6 (SUPER FIVE)	835971-845970	2

YEAR	MODEL IDENTIFICATION	SERIAL NUMBER RANGE	# of CYL
1955	WM-7 (SUPER TEN)	826920-830919	2
1955	WM-7 (SUPER TEN)	915751-917750	2
1955	WN-7 (POWERMATIC 12)	845973-851972	2
1956	WH-6 (SUPER FIVE)	835971-845970	2
1956	WM-7A (SUPER TEN)	917751-922750	2
1956	WN-7A (POWERMATIC 12)	923251-931750	2
1956	WA-25 (SUPER POWER 25)	907751-912750	4
1956	WA-25E (SUPER POWER 25)	912751-913755	4
1957	WH-6A (SUPER FIVE)	931751-UP	2
1957	WM-7A (SUPER TEN)	917751-UP	2
1957	WN-7A (POWERMATIC 12)	923251-UP	2
1957	WA-25 (SUPER POWER 25)	1012962-UP	4
1957	WA-25E (SUPER POWER 25)	1018662-UP	4
1957	POWERMATIC 15	OC1575	2